

**WELDON**

Chain for diary  
industry

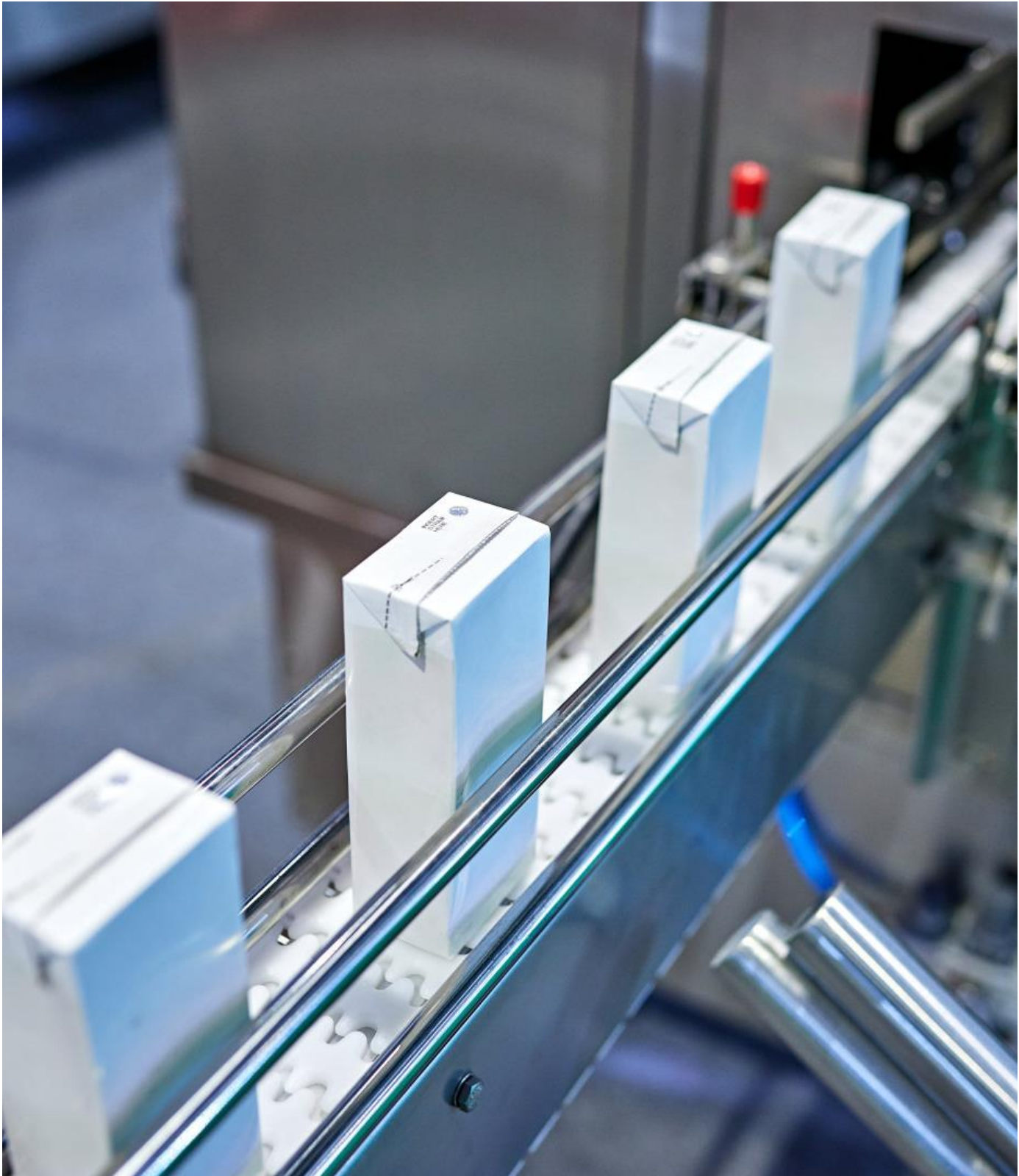

**WELDON**





Multiflex chains are ideal for application in multi - track rails.  
Suitable for TeaPak dairy conveying line.

**WELDON**



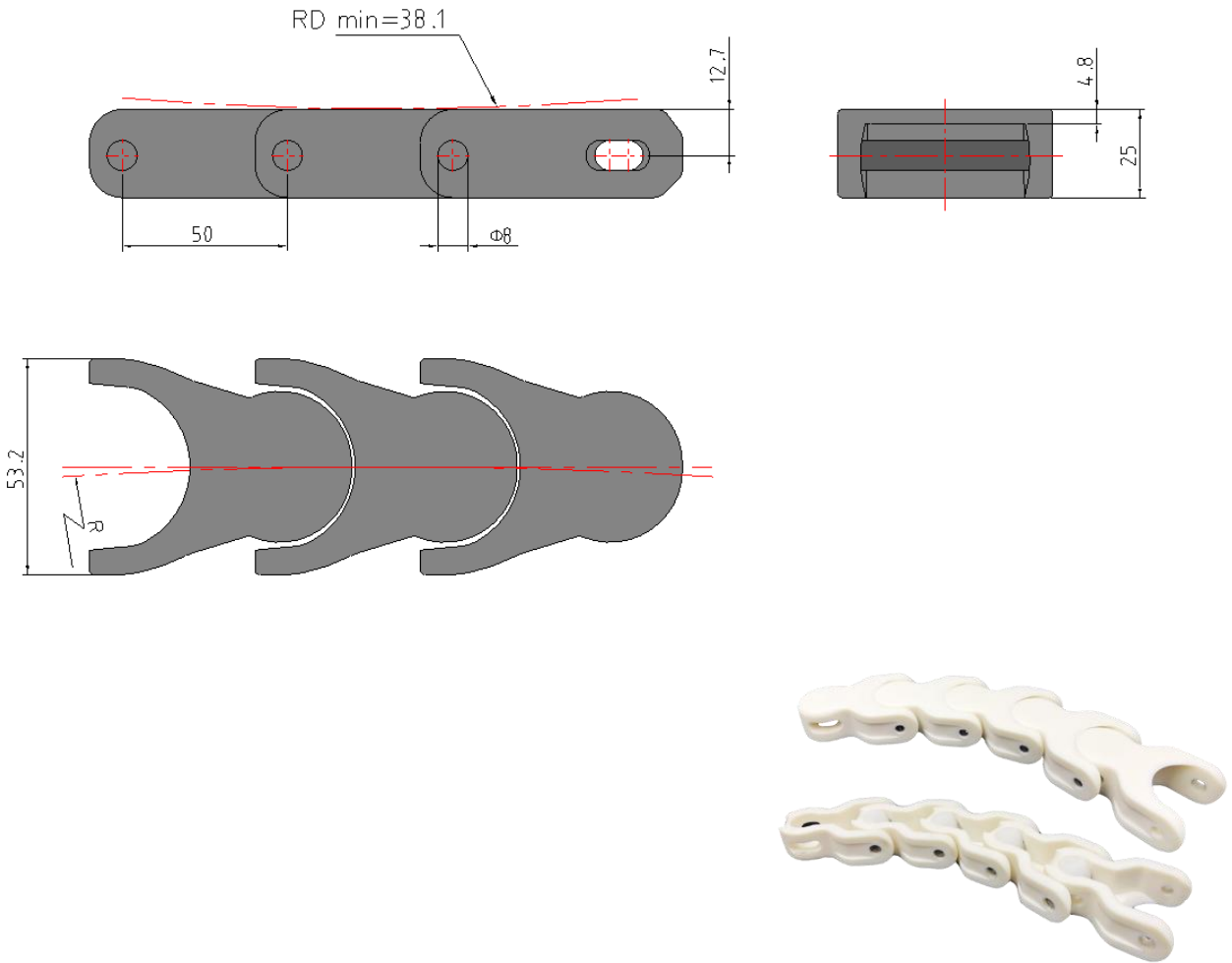

Model no.	Width	Plate thickness	Working load (max)	Weight	R min	R min
	mm	mm	N	Kg/m	mm	mm
MT1700-53.2	53.2	25	2670	1.43	140	38



# 1760 SERIES MULTIFLEX CHAIN

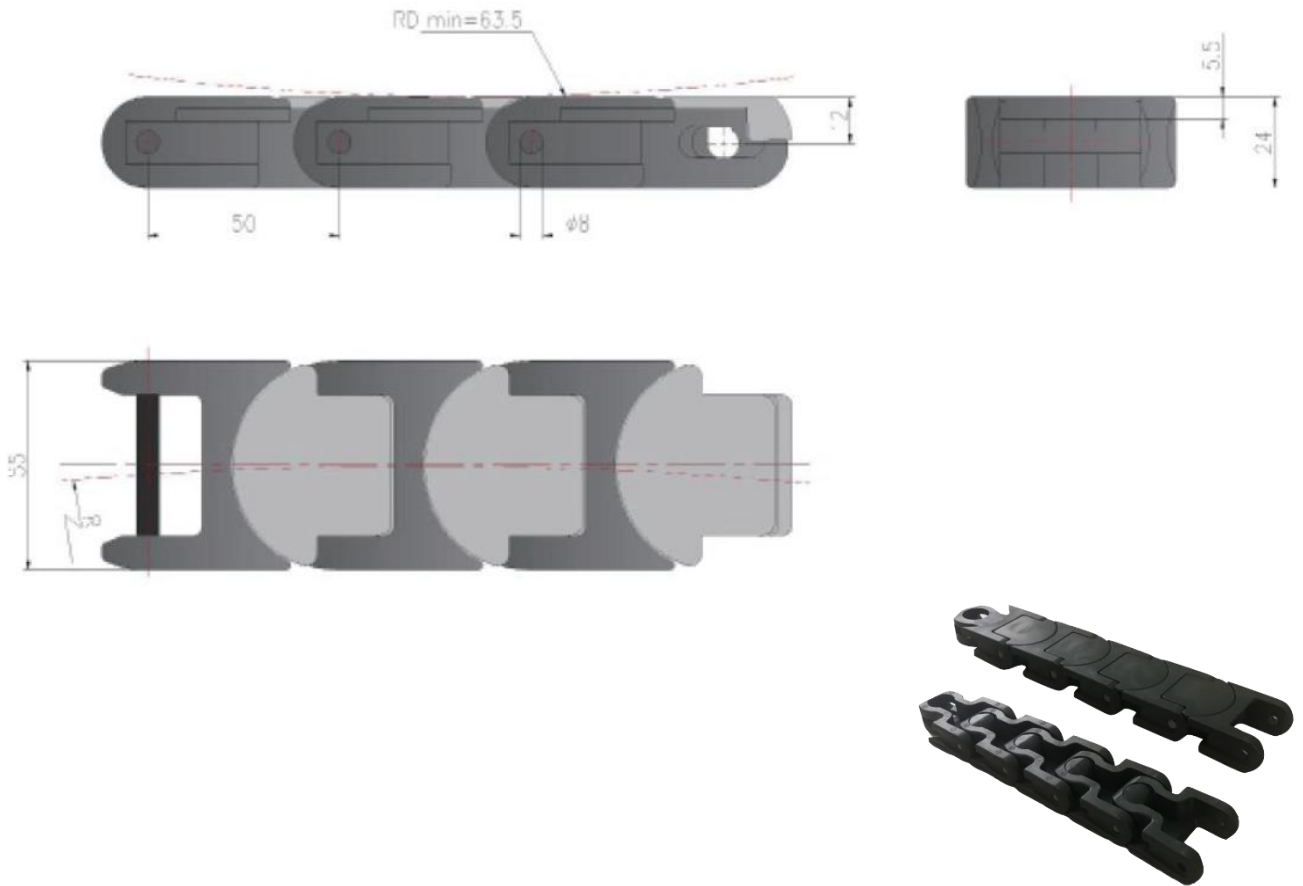

Model no.	Width	Plate thickness	Working load (max)	Weight	R min	R min
	mm	mm	N	Kg/m	mm	mm
MT1760-55	55	24	2670	1.46	125	63.5

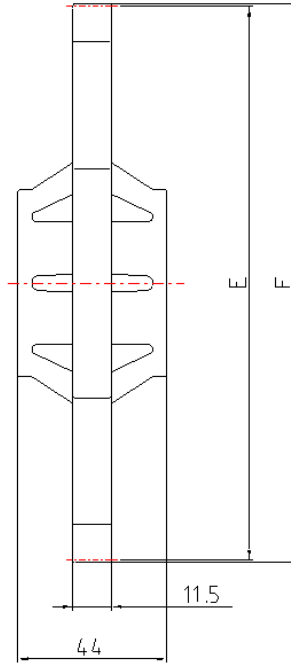
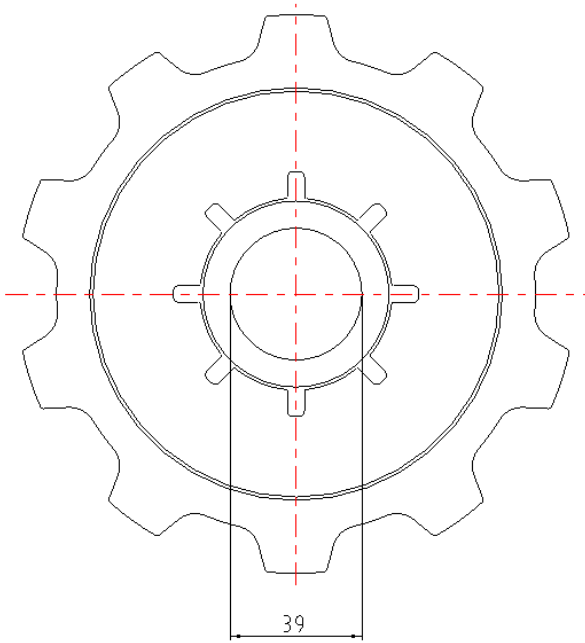

Name	Model no.	Teeth no.	Bore mm	Pitch diameter mm	Outside diameter mm	Hub width mm
Sprocket for 1700 and 1760 multiflex chain	SC1700-10-R30	10	30	161.8	165.1	44



**WELDON**

It is suitable for the occasion of low load strength and smooth operation. The connecting structure makes the chain more flexible, and can realize the minimal turning radius of the clamping conveyor chain.



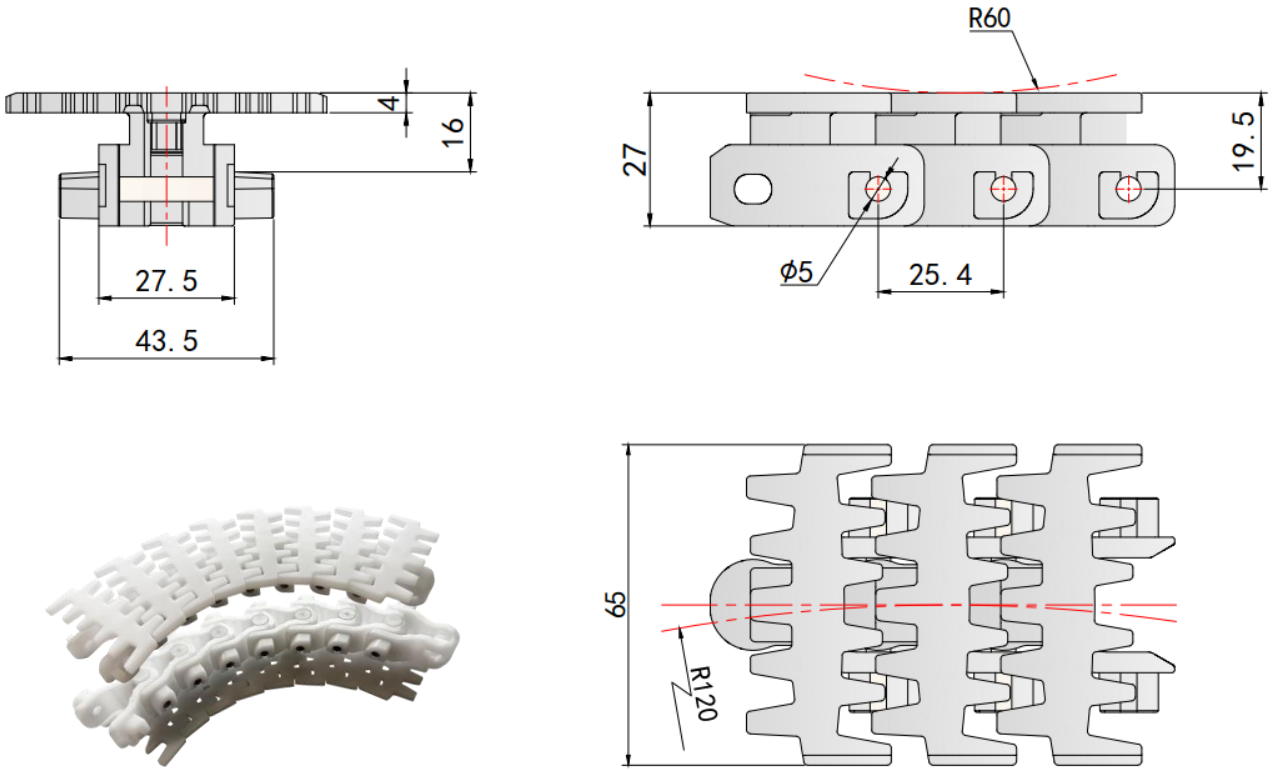

Model no.	Width		Pitch	Min radius	Weight
	mm	inch			
CC65	65	2.56	25.4	120	0.81

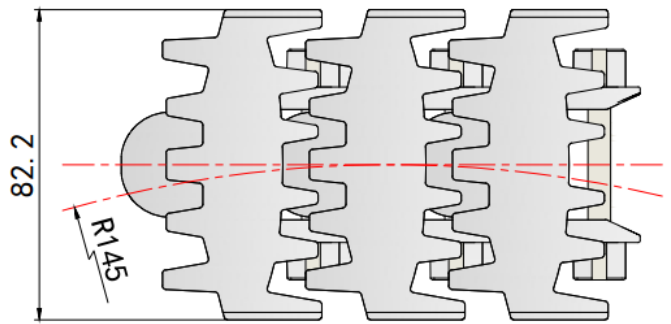
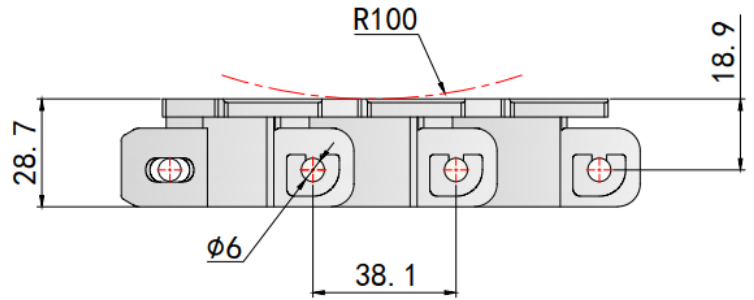
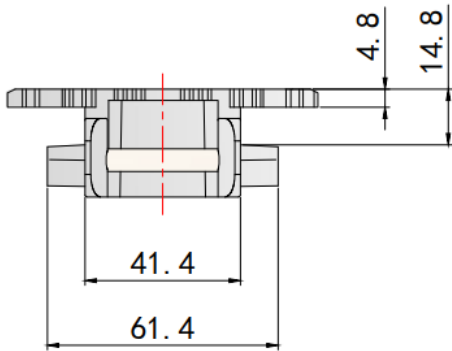

Model no.	Width		Pitch	Min radius	Weight
	mm	inch			
CC82	82.2	3.24	38.1	145	1.3





**WELDON**

Weldon provides professional solution.

Company: Yangzhou Weldon Transmission Equipment Co.,Ltd

Address: SHUANGTANG INDUSTRIAL PARK, GANQUAN, YANGZHOU, JIANGSU, CHINA

Telephone: + 8 6 - 0514-87727309

**E - Mail :** yzhdn@163.com

Website: [www.weldonchains.com](http://www.weldonchains.com)



WeChat subscription



Weldon's private WeChat