

HSF

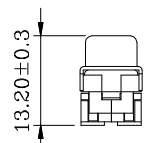
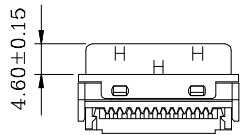
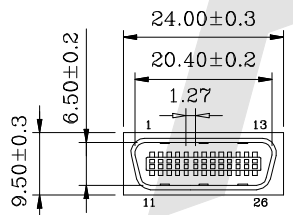
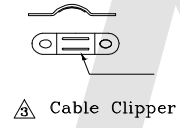
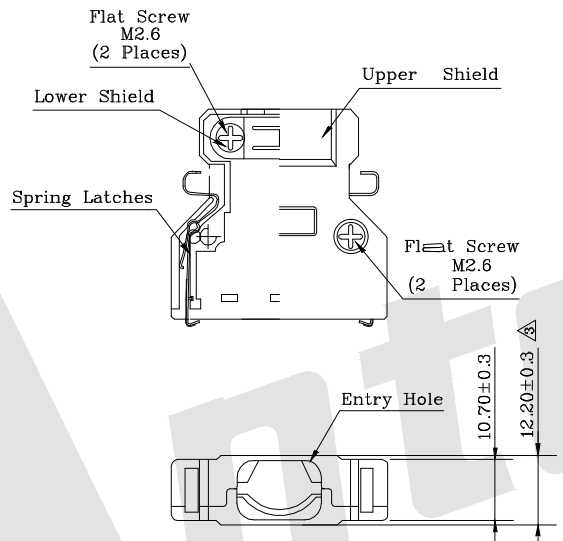
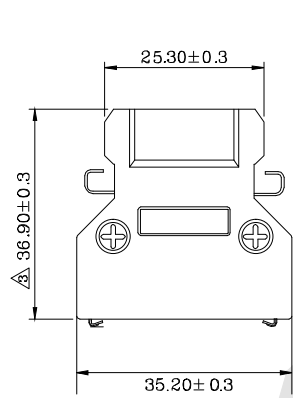

FEATURES:

- Round cable Straight exit
- Strain Relief Straple With Spring latches
- Back shell desing by Die-Cast
- Excellent EMI/RFI protection

MATERIALS:

- Back Shell:Zinc plate nickel over copper
- Spring latches:phosphor bronze over nickel
- Screw:stell nickel plated over copper
- Cable Clipper:stell nickel plated

HPMCS02CNI-26X-S
① ②

① ENTRY HOLE SIZES

- 7=7.0mm
- 9=9.0mm
- 11=11.0mm

② Retention Features:

S=Backshell selective gold plated

Unless Otherwise specified tolerance
X. ±0.35 X.XX: ±0.20
X.X: ±0.25 X.XXX: ±0.15

Antenk® ANTENK ELECTRONICS CO., LTD
Http://www.antenk.com
E-mail:sales@antenk.com

SCALE: As Shown	UNIT: mm
DRAW Jack Bao	DATE 8/23/2018
CHECK Bob Yang	DATE 8/23/2018

TITLE: 1.27mm Series Shielded Backshell Kits 26P
Straight Exit With Spring Latches and Connector
IDC Molded Ribbon Type

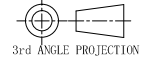

DRAWING NO: HPMCS02CNI-26XS
PRODUCT NO: HPMCS02CNI-26XS

REV	DESCRIPTION	DATE
1		
2		
3		
4		
5		